

# PERCH LAKE

T. 49 N. - R. 18 W.

ST. LOUIS COUNTY

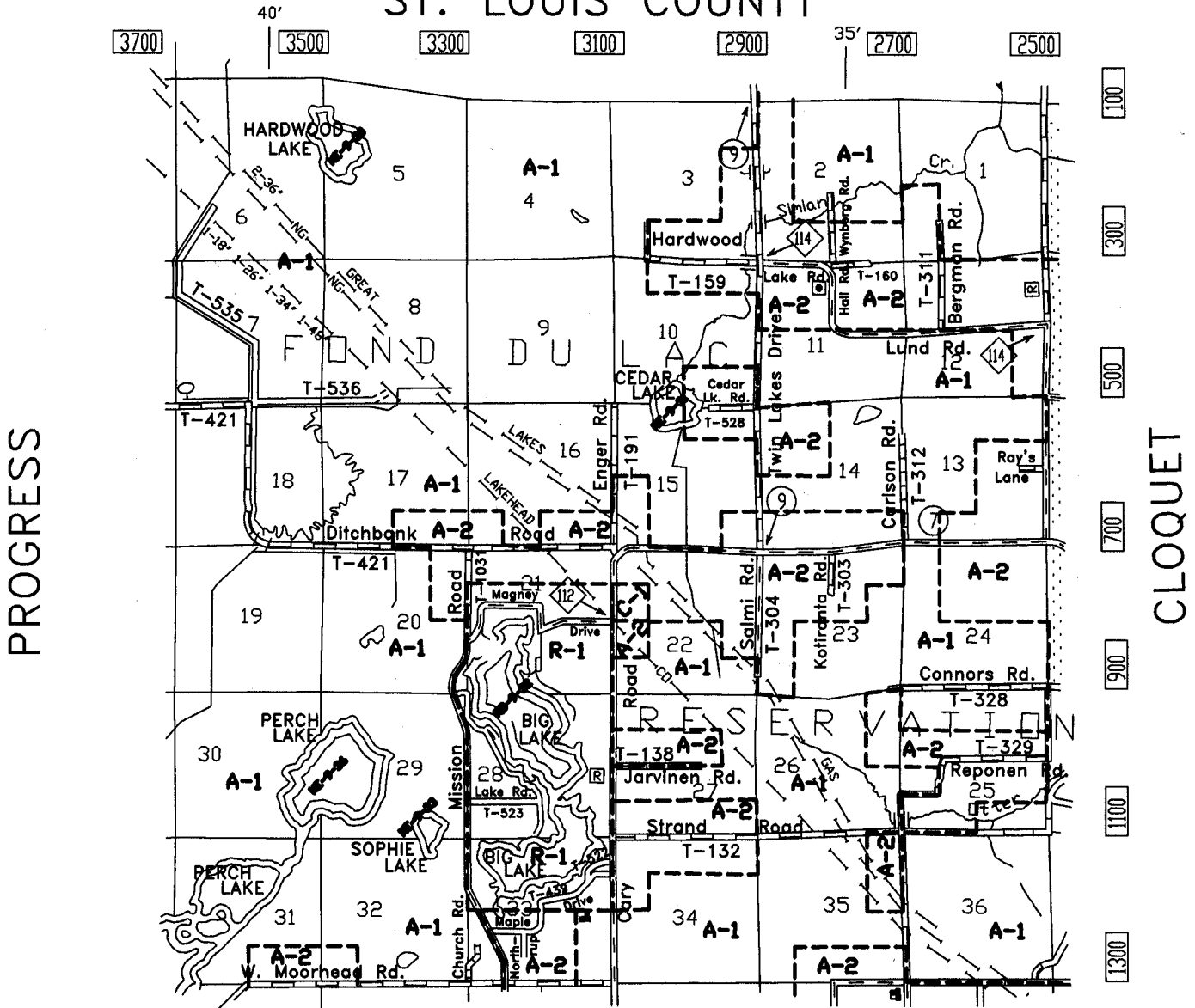

## SAWYER-ATKINSON

- LEGEND**
- A-1 AGRICULTURE/FOREST MANAGEMENT
  - A-2 AGRICULTURE/RURAL RESIDENTIAL
  - C-1 COMMERCIAL RECREATION
  - C-2 HIGHWAY COMMERCIAL
  - M-1 LIMITED INDUSTRIAL
  - R-1 RECREATION RESIDENTIAL

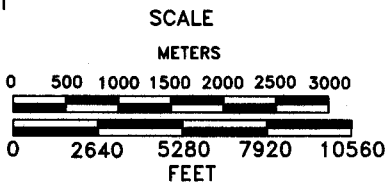

- LEGEND**
- STATE HIGHWAY =
  - COUNTY STATE AID HIGHWAY =
  - COUNTY HIGHWAY =
  - TOWNSHIP ROADS =
  - UNORGANIZED TOWNSHIP ROADS =
  - TELEPHONE LINES =
  - NATURAL GAS LINES =
  - TRANSMISSION LINES =
  - FEDERAL AID PRIMARY =
  - FEDERAL AID SECONDARY =
- F.A.P.  
F.A.S.